

Creating an App-Password if you have 2-Step Authentication

In case you have set up your Connect Account to have 2-Step Verification, you may have noticed that you are unable to get your mail client to connect to your Connect Account.

To fix this, you will need to do the following:

First, log onto your Connect account by going to:

<https://mail.google.com/a/ucsb.edu>

Next, sign in with your Connect Account email address and password.

The system will ask you to verify that you are logging in if you haven't connected to your Google Account on your browser, so be sure to verify you are connecting there.

Once you are logged in, go to the upper right hand corner, which should look similar to this:

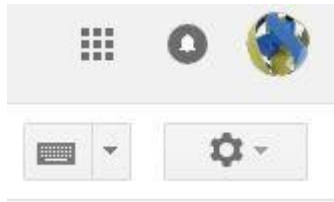

We will want to click on the circle item in the upper right hand corner. It will have a new menu, we want to click on the blue button that shows My Account.

When you do, it will pull up a new tab that should look similar to this:

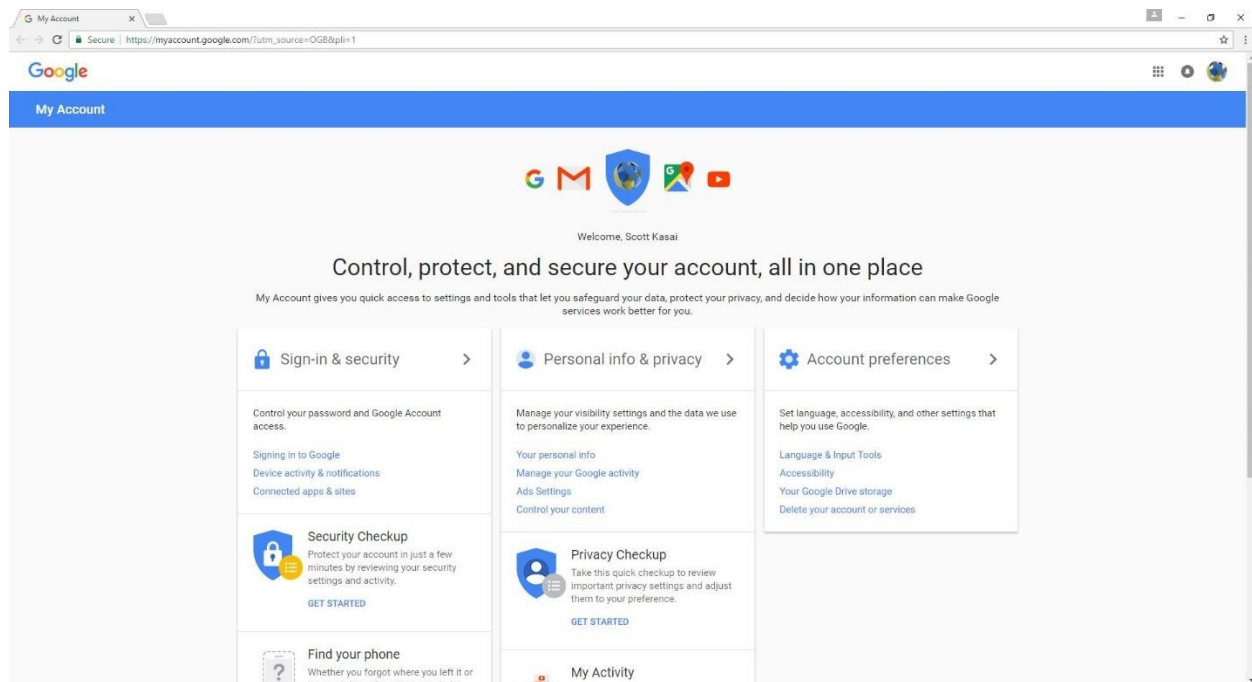

We will want to click on the Sign-in& security portion of this page:

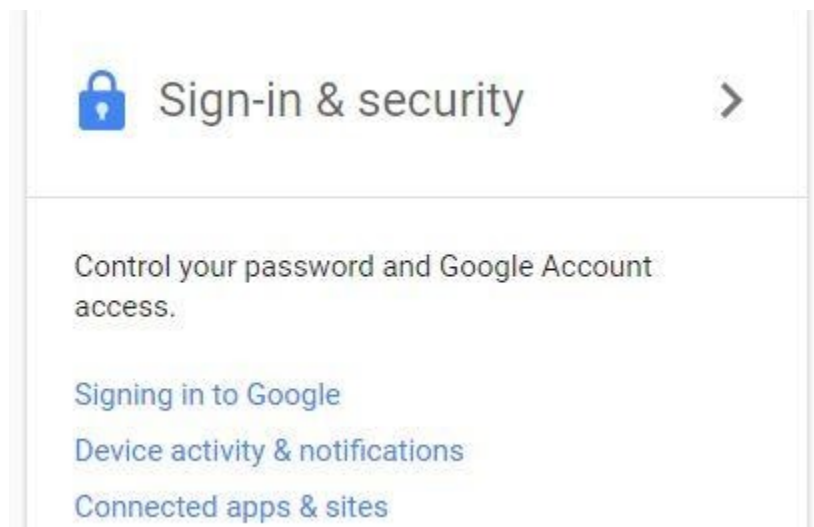

A new view will show, so we want to scroll down a little and find this section:

Password & sign-in method

Your password protects your account. You can also add a second layer of protection with 2-Step Verification, which sends a single-use code to your phone for you to enter when you sign in. So even if somebody manages to steal your password, it is not enough to get into your account.

Note: To change these settings, you will need to confirm your password.

Password	Last changed: September 4, 2015	>
2-Step Verification	On since: November 9, 2015	>
App passwords	3 passwords	>

From here, click on the App passwords section.

Google will ask you to verify who you are once again with this window:

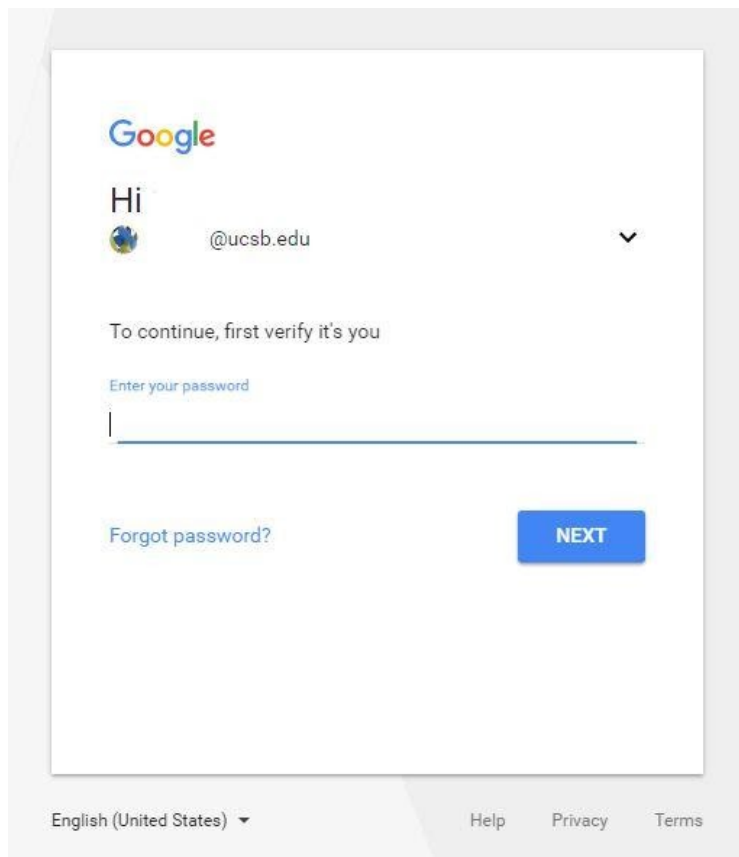

Just answer it again as you did before. Once you do, you should see this:

← App passwords

App passwords allow 2-Step Verification users to access their Google Accounts through apps such as Mail on an iPhone or Mac, or Outlook. We'll generate the app passwords for you, and you won't need to remember them. [Learn more](#)

Name	Created	Last used	Access
K9 App	Apr 27	9:48 AM	REVOKE
Thunderbird	Apr 27	7:44 AM	REVOKE
Outlook	Apr 27	Apr 28	REVOKE

[Select app](#) ▼ on my [Select device](#) ▼ [GENERATE](#)

This is where we will define an Application Password that you will use for applications like Thunderbird or other Mail/Calendar Applications that don't use the Google 2-Step Verification method or the Google Sync Application.

Under Select app button, you will want to select Other and type out the name of the Application you will want it to connect to. We recommend you also specify the type of device/computer you are connecting to, for example:

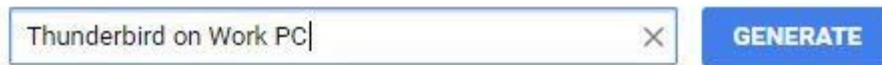

The image shows a text input field containing the text "Thunderbird on Work PC" with a close button (X) on the right. To the right of the input field is a blue button with the text "GENERATE" in white capital letters.

We are describing this as connecting to Thunderbird on a Work PC. You ideally want to keep each application separate, in case a computer gets stolen or compromised, you can revoke only that password without affecting other applications.

You will see a screen similar to the following when it generates the password:

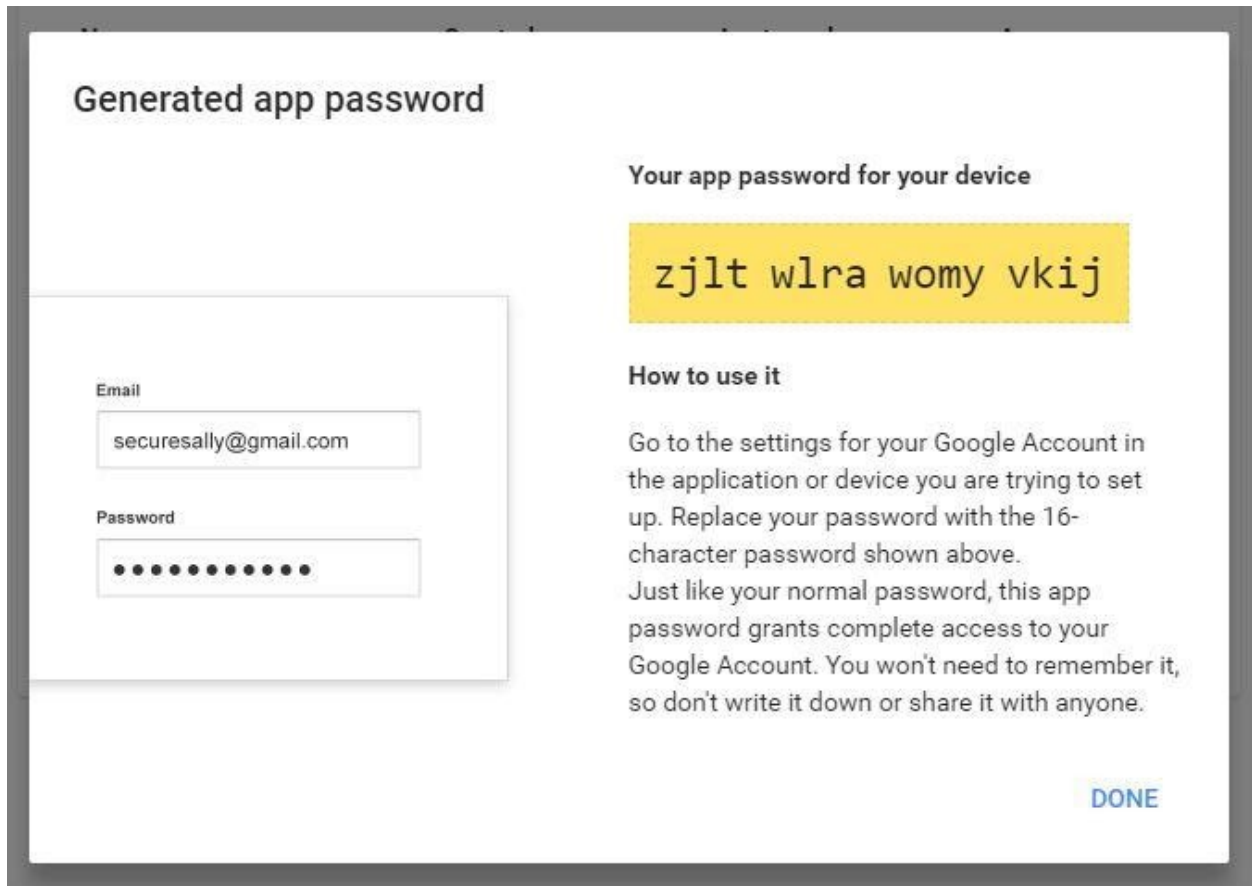

This tells you don't have to remember this password.

However, you will need to make sure to Save the password on your application.

You will not be able to refer back to the password once you hit Done on this screen.

Your only choice is to Revoke it and Generate a new App Password for the application.

Related Articles

- [Creating an App-Password if you have 2-Step Authentication](#) (ECI Public Knowledgebase)
 - [kb-connect](#)
 - [connect](#)
 - [mfa](#)
 - [app-password](#)
 - [google](#)

- [Two-Factor, Two-Step or Multi-Factor Authentication](#) (ECI Public Knowledgebase)
 - [kb-security](#)
 - [kb-how-to-article](#)
 - [2fa](#)
 - [mfa](#)
 - [two-step-verification](#)
 - [verification](#)
- [Configuring Thunderbird to use UCSB Connect](#) (ECI Public Knowledgebase)
 - [kb-connect](#)
 - [thunderbird](#)
 - [connect](#)
 - [gmail](#)
 - [configure](#)
- [General IMAP Configuration Information for UCSB Connect Account](#) (ECI Public Knowledgebase)
 - [kb-connect](#)
 - [connect](#)
 - [gmail](#)
 - [configure](#)
- [General Recommendations for Mail Clients for UCSB Connect](#) (ECI Public Knowledgebase)
 - [kb-connect](#)
 - [connect](#)
 - [gmail](#)
 - [configure](#)
- [UCSB Connect Support Documents](#) (ECI Public Knowledgebase)
 - [kb-connect](#)
 - [connect](#)
 - [gmail](#)
 - [support](#)
- [I am not getting mail from the mailing list.](#) (ECI Public Knowledgebase)
 - [mailing-list](#)
 - [connect](#)
 - [kb-troubleshooting-article](#)
- [Can't get onto UCSB Connect/GMail](#) (ECI Public Knowledgebase)
 - [gmail](#)
 - [connect](#)
 - [kb-troubleshooting-article](#)
- [There is no email on my Engineering Account.](#) (ECI Public Knowledgebase)
 - [kb-troubleshooting-article](#)
 - [connect](#)
 - [mail](#)
 - [forward](#)
 - [email](#)
- [Configuring Android with UCSB Connect](#) (ECI Public Knowledgebase)
 - [kb-connect](#)
 - [connect](#)
 - [android](#)
 - [tablet](#)
 - [gmail](#)
- [I am getting a Delivery Status Notification about my Vacation Message](#) (ECI Public Knowledgebase)
 - [vacation](#)
 - [connect](#)
 - [mail](#)
 - [failure](#)
 - [kb-troubleshooting-article](#)
- [Configuring Windows 10 Mail and Calendar to use UCSB Connect](#) (ECI Public Knowledgebase)
 - [kb-connect](#)
 - [pc](#)
 - [connect](#)
 - [gmail](#)
 - [configure](#)
- [Configuring Connect Calendar in Thunderbird](#) (ECI Public Knowledgebase)
 - [kb-connect](#)
 - [calendar](#)
 - [thunderbird](#)
 - [connect](#)
 - [configure](#)
- [How do I find out what my email address?](#) (ECI Public Knowledgebase)
 - [email](#)
 - [connect](#)
 - [gmail](#)
 - [alias](#)
 - [kb-how-to-article](#)

- [How do I log into my Engineering email? \(ECI Public Knowledgebase\)](#)
 - [connect](#)
 - [mail](#)
 - [login](#)
 - [engineering](#)
 - [kb-troubleshooting-article](#)